

INSTALLATION MANUAL

65662BT

LED
BUILT IN



90
CRI

CE ENEC UK CA

RoHS
COMPLIANT



NOT
DIMMABLE

230V | COB LED | 28W | IP20 | Adjustable beam | Aluminium

Complete with 700mA driver.

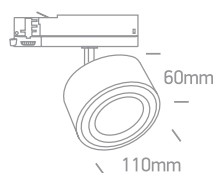
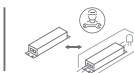

one
LIGHT

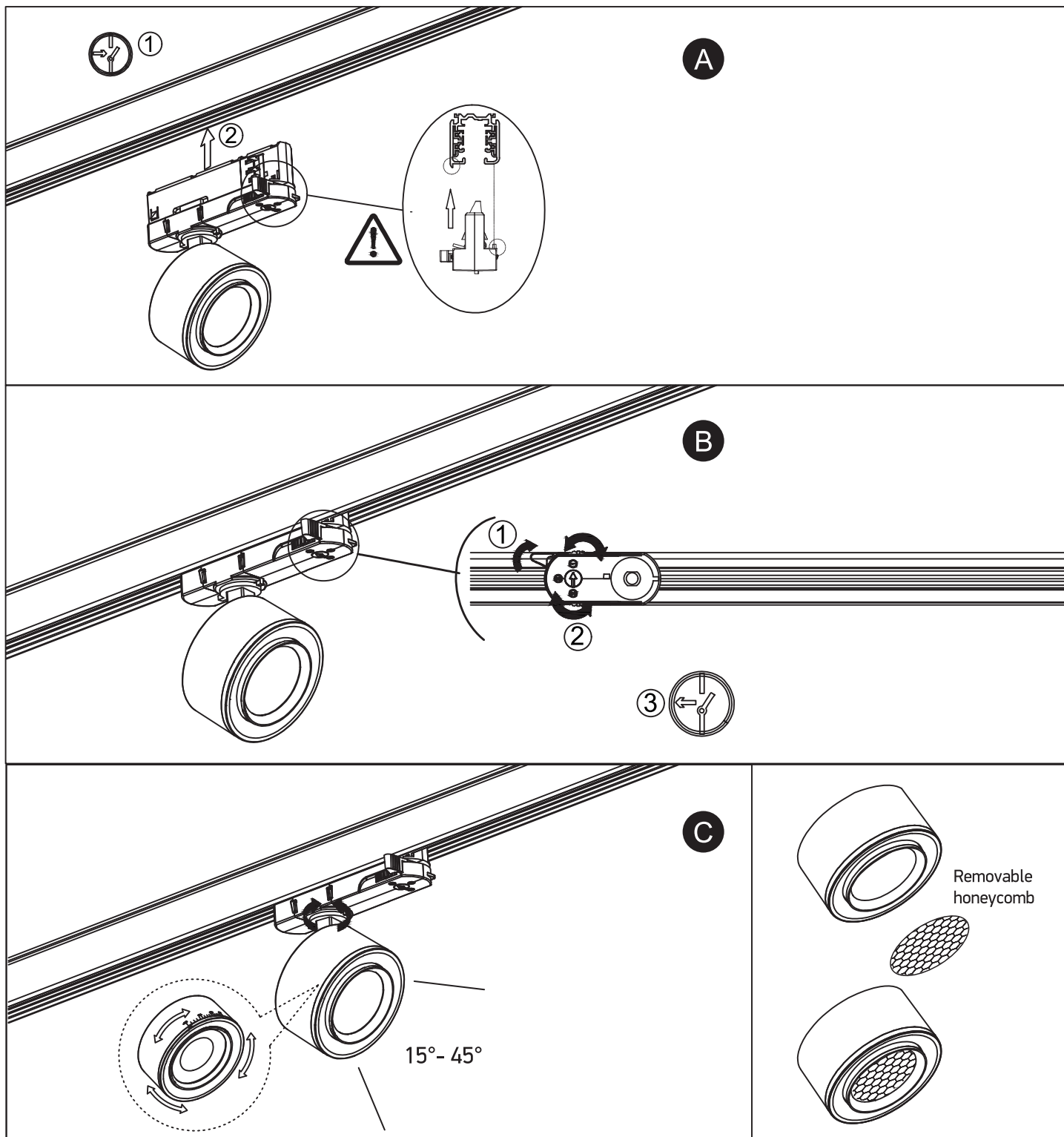

Warnings:

1. Make sure that the product is installed properly before connecting to electricity.
2. Do not cover the fitting.
3. Maintenance and installation should only be carried out by a professional electrician.